



**BESPOKE**  
STAIRLIFTS LTD.

# INFINITY

## TECHNICAL INFORMATION

January 2025

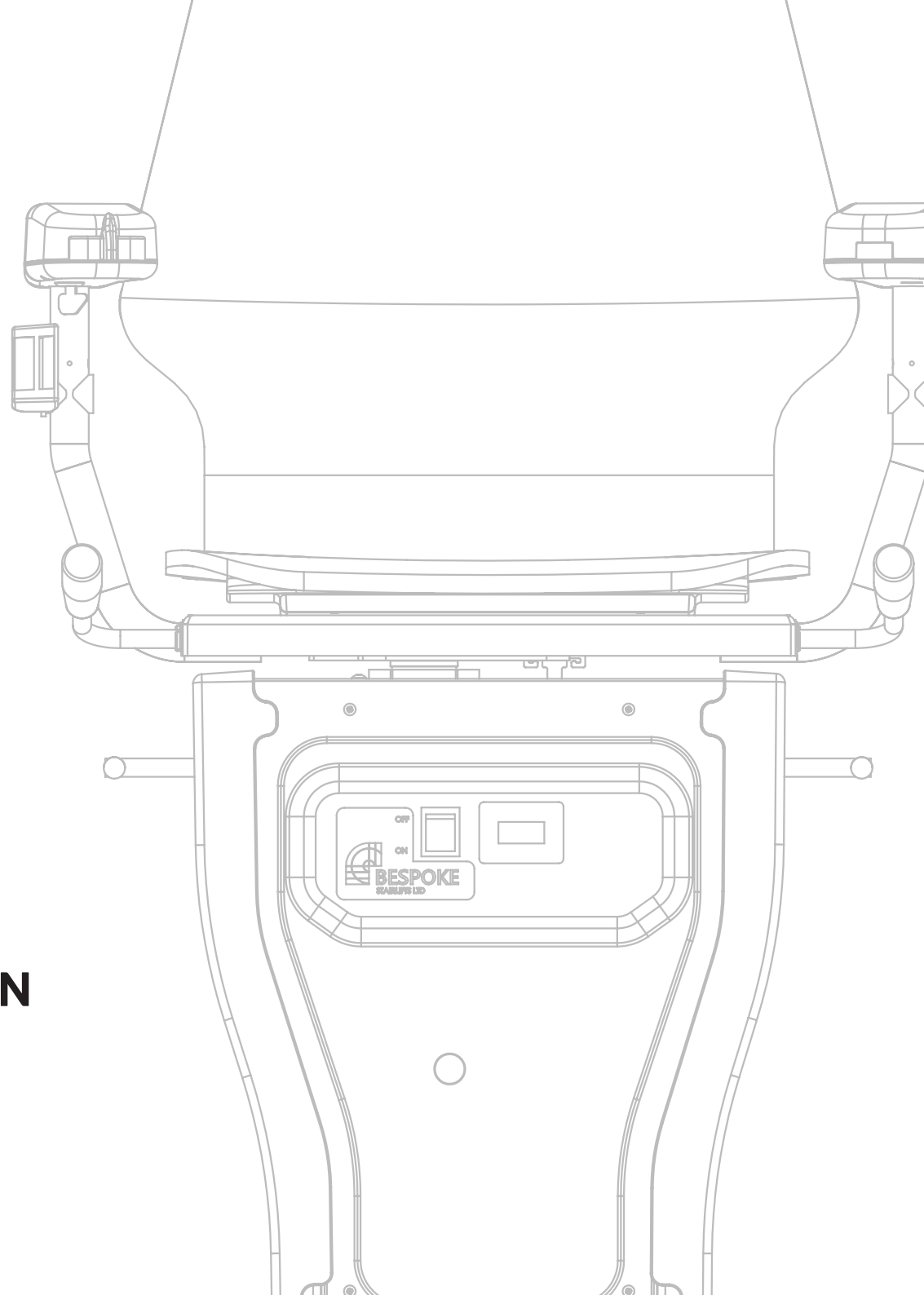



<b>A</b>	<b>Total height (from floor)</b>	1058mm
<b>B</b>	<b>Height of arms (from floor)</b>	837mm
<b>C</b>	<b>Seat height (from floor)</b>	594mm
<b>D</b>	<b>Total width</b>	607mm
<b>E</b>	<b>Width of footrest</b>	300mm
<b>F</b>	<b>Total depth (from wall)</b>	622mm
<b>G</b>	<b>Seat depth (to backrest)</b>	385mm
<b>H</b>	<b>Depth of footrest</b>	270mm
<b>I</b>	<b>Footrest to seat</b>	493mm
<b>J</b>	<b>Total depth (folded)</b>	407mm
<b>K</b>	<b>Total height (folded)</b>	1078mm

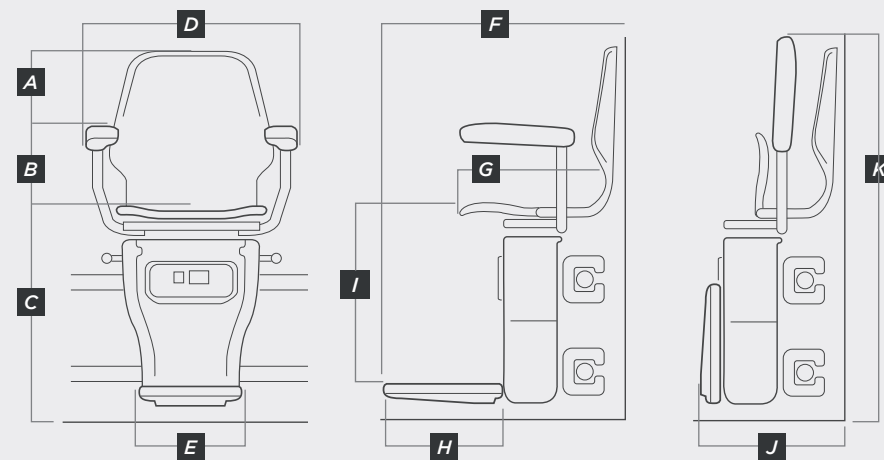

**Power Supply:** Input 120v-240v  
Output 1.2Ah  
**Battery:** 2x 12v  
**Rail Drive:** Rack & Pinion  
**Max. seat rotation:** 80°  
**Max user weight:** 125kg (19.5 stone)  
HD160Kg (25 stone)

Stairlift can fit to a minimum  
of 650mm staircase width

**IMPORTANT:**

**BACK TO KNEE TO BE  
130mm LESS THAN WIDTH  
FOR NO CLASH**

**Minimum parking space:**  
600mm

**Minimum stair angle:**  
0°

**Maximum stair angle:**  
50°

**Turning requirements**

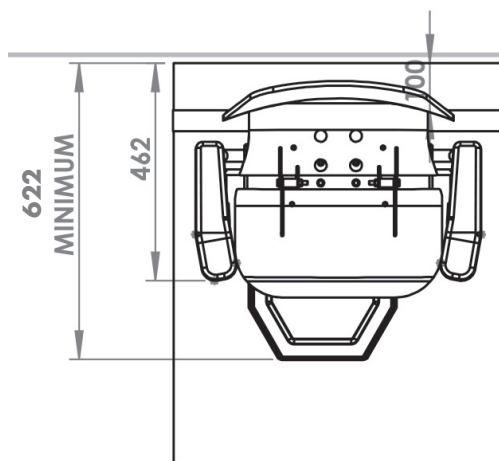

**Travel Position**

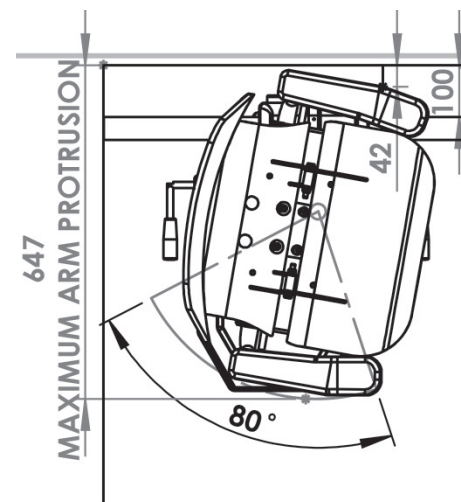

**Swivel Position**

# Start and finish requirements

